

## Stainless Steel-Levelling feet

Female thread

### SPECIFICATION

#### Types

- Type **OS**: without plastic cap
- Type **KS**: with plastic cap, gliding
- Type **KR**: with plastic cap, non-gliding
- Type **KSE**: with plastic cap, gliding, electrically conductive (antistatic)
- Type **KRE**: with plastic cap, non-gliding, electrically conductive (antistatic)

Stainless Steel AISI 303

Type **KS / KSE**

Plastic cap Polyacetal (POM)

KS: white (natural colour) RAL 9001

KSE: black, electrically conductive

Surface resistivity:  $< 10^6 \Omega$

Volume resistivity:  $< 10^7 \Omega$

DIN EN 61340-5-1 / 61340-2-3

Type **KR / KRE**

Plastic cap elastomer (TPE), 78 Shore A  $\approx$

KR: black

KRE: black, electrically conductive

Surface resistivity:  $< 10^6 \Omega$

Volume resistivity:  $< 10^7 \Omega$

DIN EN 61340-5-1 / 61340-2-3

### INFORMATION

The static load of the Stainless Steel-Levelling feet GN 343.5 is limited by the load capacity of the ball joint (AISI 303).

The static load values (only valid for Type OS, KS and KSE) in the above table refer to a net vertical load in relation to the levelling foot. Under normal operating conditions side loading or angular loading is not uncommon and the load capacity would be considerably reduced which must be taken into consideration.

Levelling feet GN 343.5 cannot be disassembled.



### TECHNICAL INFORMATION

- Stainless Steel characteristics (see page A26)
- Elastomer characteristics (see page A32)
- Plastic characteristics (see page A2)

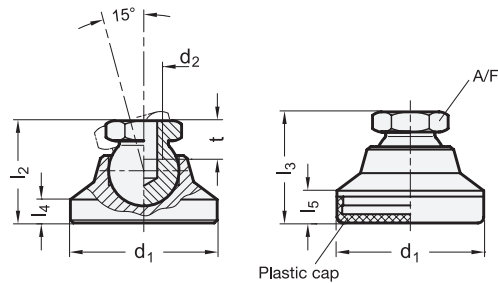

\*Complete with type index of the Levelling feet

OS KS KR KSE KRE

### GN 343.5

STAINLESS STEEL

Description	d1	d2	l2	l3	l4	l5	A/F	t min.	⚖
GN 343.5-25-M6-*	25	M 6	19	20.5	4	5.5	12	9	30
GN 343.5-25-M8-*	25	M 8	19	20.5	4	5.5	12	9	25
GN 343.5-32-M8-*	32	M 8	23	24.5	5	6.5	12	9	57
GN 343.5-32-M10-*	32	M 10	23	24.5	5	6.5	15	10.5	55
GN 343.5-40-M10-*	40	M 10	26	27.5	6	7.5	15	10.5	110
GN 343.5-40-M12-*	40	M 12	26	27.5	6	7.5	17	11.5	99
GN 343.5-50-M10-*	50	M 10	28	29.5	7	8.5	15	10.5	170
GN 343.5-50-M12-*	50	M 12	28	29.5	7	8.5	17	11.5	161
GN 343.5-60-M12-*	60	M 12	36	37.5	8.5	10	17	11.5	320
GN 343.5-60-M16-*	60	M 16	36	37.5	8.5	10	24	16	305

Weight type KR